



user manual

Instrukcja obsługi | Руководство пользователя
Manuel de l'Utilisateur | Betriebsanweisung
Bruksanvisning | Manual del Usuario
Betjeningsvejledning | Gebruikershandleiding
Käyttöohjeet | Manual de utilizare | Bruksanvisning
Manuale d'uso | Příručka uživatele | Navodila
za uporabo

Retain for future use
Zachować do przyszłego użytku
Сохраните для последующего
использования
A conserver pour une utilisation future
Für zukünftige Benutzung aufbewahren
Behold for senere bruk
Säilytä nämä käyttöohjeet tulevaa tarvetta marten
Opbevar manualen til fremtidig brug
Bewaren voor gebruik in de toekomst
Conservare il presente manuale a l'uso futuro
Păstrați acest manual pentru utilizare viitoare
Conservar para futuras consultas
Behall för framtida användning
Uchovejte pro další použití
Hranite za prihodnjo uporabo

Wood-Mizer®

Cookie-Mizer

Safety, Operation, Maintenance and Replacement Parts

Cookie-Mizer

rev. A1.00



Safety is our #1 concern! Read and understand all safety information and instructions before operating, setting up and/or maintaining this machine.

Form #2510

Table of Contents

Section-Page

General Contact Information
Branches & Authorized Sales Centers
Wood-Mizer Locations (North and South America)

SECTION 1	SAFETY	1-1
1.1	Safety Symbols.....	1-1
1.2	Safety Instructions.....	1-1
	<i>Observe safety instructions</i>	
	<i>Wear Safety Clothing</i>	
	<i>Keep Cookie-Mizer and Area Around Cookie-Mizer Clean</i>	
	<i>Heavy Material</i>	
	<i>Dispose of sawing by-products properly</i>	
	<i>Keep Hands Away</i>	
	<i>Keep Safety Labels In Good Condition</i>	
	<i>Working With Heavy Logs</i>	
SECTION 2	ASSEMBLY	2-1
2.1	Mounting for LT15.....	2-1
2.2	Mounting for LX100.....	2-2
2.3	Mounting for LT20/40/70.....	2-3
2.4	Mounting for LT20B.....	2-3
2.5	Mounting optional additional spacers.....	2-6
SECTION 3	SETUP	3-1
SECTION 4	OPERATION	4-1
SECTION 5	SPECIFICATIONS	5-1
5.1	Overall Dimensions.....	5-1
5.2	Material Parameters.....	5-1

Getting Service

Wood-Mizer is committed to providing you with the latest technology, best quality and strongest customer service available on the market today. We continually evaluate our customers' needs to ensure we're meeting current wood-processing demands. Your comments and suggestions are welcome.

General Contact Information

From Europe call your local distributor or our European Headquarters and Manufacturing Facility in Koło, Nagórna 114 St, Poland at **+48-63-2626000**. From the continental U.S., call our U.S. Headquarter 8180 West 10th St. Indianapolis, IN 46214, toll-free at **1-800-525-8100**. Ask to speak with a Customer Service Representative. Please have your machine identification number and your customer number ready when you call. The Service Representative can help you with questions about the operation and maintenance of your machine. He also can schedule you for a service call.

Office Hours:

Country	Monday - Friday	Saturday	Sunday
Poland	7 a.m.- 3 p.m.	Closed	Closed
US	8 a.m.- 5 p.m.	8 a.m.- 12 p.m	Closed

Please have your vehicle identification number and your customer number ready when you call.

Wood-Mizer will accept these methods of payment:

- Visa, Mastercard, or Discover
- COD
- Prepayment
- Net 15 (with approved credit)



Be aware that shipping and handling charges may apply. Handling charges are based on size and quantity of order.

Technical data are subject to change without prior notice.

Actual product may differ from product images. Some illustrations show machines with optional equipment.

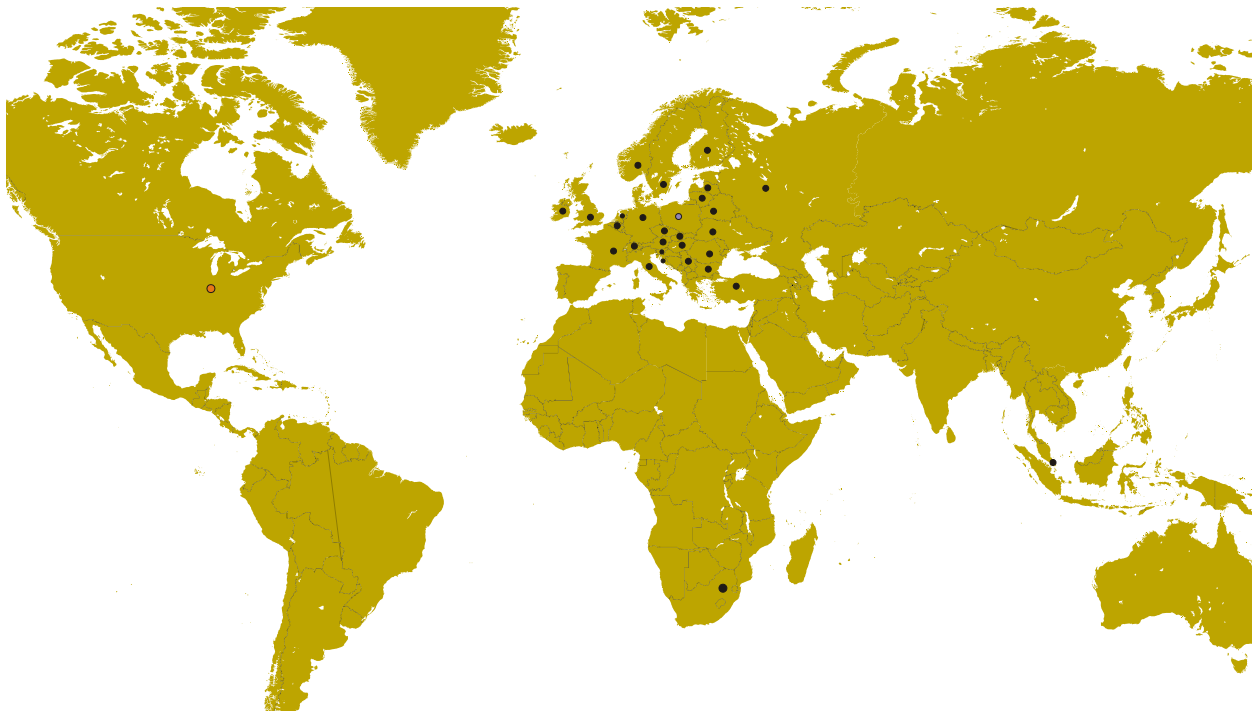
Branches & Authorized Sales Centers Wood-Mizer Locations (North and South America)



EUROPE		UNITED STATES
<p> European Headquarters Wood-Mizer Industries Sp. z o.o. Nagórna 114, 62-600 Kolo, Poland Tel.: +48-63-26-26-000 Fax: +48-63-27-22-327 www.woodmizer.eu</p>		<p> World Headquarters Wood-Mizer LLC 8180 West 10th Street Indianapolis, Indiana 46214-2400, USA Tel.: +1-317-271-1542 Fax: +1-317-273-1011 www.woodmizer.com</p>
<p>BELARUS MOST-GRUPP Siemashko 15, k.3 Minsk 2200116 Tel.: +375-17-270-90-08 Fax: +375-17-270-90-08 GSM: +375-29-649-90-80 e-mail: most-by@mail.ru</p>	<p>SWITZERLAND Stefan Wespi Maschinen u. Geräte Spezialarbeiten GmbH Eichstraße 4 6353 Weggis Tel.: +41-413-900-312 GSM: +41-799-643-594 info@woodmizer.ch www.woodmizer.ch</p>	<p>RUSSIA Dariusz Mikołajewski OOO WOOD-MIZER INDUSTRIES 141031, Moscow Reg., Mytishenski raj., pos. Veshki, Zavodskaja str., 3B Tel.Fax: +7(495) 788-72-35 Tel.Fax: +7(495) 641-51-60 e-mail: dariuszm@woodmizer-moscow.ru</p>
<p>BULGARIA Kalin Simeonov Ecotechproduct 38 Star Lozenski pat str. Sofia 1186 Tel.: +359-2-462-7035 Tel.: +359-2-963-1656 Tel./Fax : +359-2-979-1710 Kalin Simeonov GSM: +3592-963-2559 e-mail: office@ecotechproduct.com</p>	<p>HUNGARY Wiktor Turoczy Wood-Mizer Hungary K.F.T. Szonyi Ut 67., 2921 Komárom Tel./Fax: +36-34-346-255 e-mail: woodmizer@woodmizer.hu</p>	<p>RUSSIA Far East Wladimir Glazaczew "WM Service" Krasnoretchenskaya Str.111 680006 Khabarovsk Tel./Fax: +7-914-541-1183 e-mail: wms-khv@mail.ru</p>

<p>CROATIA Krešimir Pregernik Pregimex d.o.o. S. Batušićeva 31, 10090 Zagreb Tel./Fax: +3851-38-94-668 Krešimir Pregernik GSM: +3851-98-207-106 e-mail: Kresimir.Pregernik@gmail.com</p>	<p>ITALY Pasquale Felice Wood-Mizer Italia Srl Cda. Capoiaccio SN 86012 Cercemaggiore Campobasso Tel./Fax: +39-0874-798-357 GSM: +39-333-281-03-79 e-mail: wmitaliasrl@gmail.com</p>	<p>SERBIA Dragan Markov Wood-Mizer Balkan d.o.o. Svetosavska GA 3/3; P. Fah 25 23 300 Kikinda Tel./Fax: +381-230-25-754 Tel./Fax: +381-230-23-567 GSM: +381-63-568-658 e-mail: office@woodmizer.co.yu</p>
<p>CZECH REPUBLIC Miroslav Greill Wood-Mizer CZ s.r.o. Osvaldova 91 339 01 Klatovy-Luby Tel./Fax: +420-376-312-220 Fax: +420-376-319-011 Miroslav Greill GSM: +420-723-580-799 e-mail: greill@woodmizer.cz</p>		<p>SLOVAKIA Wiktor Turoczy Wood-Mizer Danubia s.r.o. Hadovce 5, 94501 Komárno Tel.: +421-35-77-40-316 Fax: +421-35-7740-326 GSM: +421-905-930-972 e-mail: woodmizer@woodmizer.sk</p>
<p>CZECH REPUBLIC Lubomir Kudlik Wood-Mizer Moravia Sovadinova 6 69002 Breclav Tel./Fax: +420-519-322-443 Lubomir Kudlik GSM: +420-602-734-792 e-mail: info@wood-mizer.net</p>	<p>LATVIA Vilmars Jansons OBERTS Ltd Gaujas str. 32/2 LV-2167 Marupe, Rigas Raj. Tel.: +371-7-810-666 Fax: +371-7-810-655 Vilmars Jansons GSM: +371-92-06-966 Andris Orols GSM: +371-28-33-07-90 e-mail: andris@oberts.lv</p>	<p>TURKEY Er-Ka Ahsap Profil Kerestecilik San. ve Tic. Ltd. Sti. Adana Keresteciler Sitesi 191 sk No.41 ADANA Tel.: +90-322-346-15-86 Fax: +90-322-345-17-07 GSM: +90-533-363-18-44 e-mail: info@erkaahsap.com.tr</p>
<p>FINLAND Howard Blackbourn Oy Falkberg Jordbruk Ab Falkintie 220 25610 Ylonkyla Tel.: +358-2732-2253 Fax: +358-2732-2263 Howard Blackbourn GSM: +358-440-424-339 e-mail: falkberg@woodmizer.fi</p>	<p>LITHUANIA Andrius Zuzevicius UAB Singlis Savanoriu pr. 187, 2053 Vilnius Tel.: +370-5-2-32-22-44 Fax: +370-5-2-64-84-15 GSM: +370-620-28-645 e-mail: andrius.z@singlis.lt</p> <p>Dmitrij Gaiduk GSM: +370-69-84-51-91 e-mail: dmitrijus.g@singlis.lt</p>	<p>UKRAINE Ivan Vinnicki MOST UKRAINA bul. Myru 3, Bajkivtsi Ternoplskyj r-j Ternopolska oblast 47711 Ukraine Tel/Fax: +38 (0352) 52 37 74 GSM: +38 (067) 352 54 34 GSM: +38 (067) 674 50 68 E-mail: most-ukraina@ukr.net</p>
<p>FRANCE Tizoc Chavez Wood-Mizer France 556 chemin des Embouffus, ZAC des Basses Echarrieres 38440 SAINT JEAN DE BOURNAY Tel: +33-4 74 84 84 44 GSM: +33-607 52 02 82 Mail: tchavez@woodmizer.fr</p>	<p>NORWAY Tor Bakken Flaathe Bakken Flaathe A/S Løkenvegen 5, 2034 Holter Tel: + 47-638 74 989 Sales: + 47- 412 80 076 Service: +47- 975 87 588 post@woodmizer.no www.woodmizer.no</p>	<p>UNITED KINGDOM & IRELAND Wood-Mizer UK Hopfield Barn Kenward Road, Yalding Kent ME18 6JP, UK Tel.: +44-1622-813-201 Fax: +44-1622-815-534 e-mail: info@woodmizer.co.uk</p>
<p>SLOVENIA Jan Fale FAMTEH d.o.o. Gacnikova pot 2, 2390 Ravne na Koroskem Tel.: +386-2-62-04-232 Fax: +386-2-62-04-231 Jan Fale GSM: +386-2-62-04-230 e-mail: jan.fale@famteh.si</p> <p>Matjaz Kolar Tel.: +386-2-62-04-232 GSM: +386-31-775-999 e-mail: matjaz.kolar@famteh.si</p>		

<p>GERMANY/AUSTRIA Klaus Longmuss Wood-Mizer GmbH Dorfstraße 5, 29485 Schletau Büro Tel: +49-5883 988 010 Werkstatt Tel: +49-5883 988 220 Ersatzteilservice Tel: +49 58 83 - 98 80 250 Schärfservice Tel: +49-58 83 - 98 80 270 E-mail: info@woodmizer.de www.woodmizer.de Klaus Longmuss Tel.: +49-5883-9880-12 GSM: +49-17-298-55-892 e-mail: KLongmuss@woodmizer.de</p>	<p>Subagent: SWEDEN Kjell Larsson Mekwood AB Slingan 14, 812 41 Gästrike-Hammarby Tel.: +46-290-515-65 Kjell Larsson GSM: +46-706-797-965 e-mail: kjell.larsson@mekwood.se</p>	<p>IRELAND Wood-Mizer Ireland Stephen Brennan Cum Lahardane Ballina County Mayo Tel:+353 96 51345 E-mail: brennanmill@ericom.net</p>
<p>Subagents: DENMARK Kevin Christiansen Kevin Christiansen's savværker PMV Arnborgvej 40, 7330 Brande- Fasterholt Mobile: +45 61468763 Mobile: +45-23495828 Info@woodmizer.dk www.woodmizer.dk</p>	<p>ROMANIA Adrian Echert SC WOOD-MIZER RO SRL TRANSILVANIEI Nr. 5 Sibiu, Cisnădie 555300 Tel./Fax: : +40-369-405-433 GSM: +40-745-707-323 e-mail: aechert@woodmizer.ro</p>	<p>Regional Manager - Asia Robert Moxham Regional Direction - Asia Wood-Mizer Asia Manufacturing Co., Ltd. No.2, Gongyequ 40th Rd. Xitun District, Taichung City, 40768, Taiwan, R.O.C. TEL: +886-4-2359 3022 FAX: +886-4-2359 3205 CELL: +886-9-0568 7708 EMAIL: RMoxham@woodmizer.com www.woodmizerasia.com Skype: r.g.moxham</p>
<p>NETHERLANDS Gerlo Breukers Breukers Houtzagerij en Bosbouwmachines Hazenweg 5, 7481 PC Haaksbergen Tel: +31-535741326 Mobile: +31-620419412 info@woodmizer.nl www.woodmizer.nl</p>	<p>Subagent: ROMANIA M. Echert S.C. Echert Comprod s.r.l Str. Schitului Nr. 6, Apt.7 etajul-1 725 70 Vatra Dornei, Romania Tel./Fax: +40-230-374-235 Tel. : +40-740-35-35-74</p>	<p>Regional Manager - Africa Gavin Prowse Regional Sales Director - Africa Wood-Mizer Africa (Pty) Ltd. Unit 1, Leader Park 20 Chariot Street Stormill Ext.5 Maraisburg, Johannesburg South Africa TEL: +27 11 473 1313 FAX: +27 11 473 2005 CELL: +27 71 398 8010 EMAIL: growse@woodmizer.com www.woodmizerafrika.com Skype: gavin.prowse</p>

USA World Headquarters

Serving North & South America, Oceania, East Asia

Wood-Mizer LLC
8180 West 10th Street
Indianapolis, IN 46214

Phone: 317.271.1542 or 800.553.0182
Customer Service: 800.525.8100
Fax: 317.273.1011
Email: infocenter@woodmizer.com

Canadian Headquarters

Serving Canada

Wood-Mizer Canada
396 County Road 36, Unit B
Lindsay, ON K9V 4R3

Phone: 705.878.5255 or 877.357.3373
Fax: 705.878.5355
Email: ContactCanada@woodmizer.com

Brazil Headquarters

Europe Headquarters



Serving Brazil

Wood-Mizer do Brasil
Rua Dom Pedro 1, No: 205 Bairro: Sao Jose
Ivoti/RS CEP:93.900-000

Tel: +55 51 9894-6461/ +55 21 8030-3338/ +55 51 3563-4784
Email: info@woodmizer.com.br

Serving Europe, Africa, West Asia

Wood-Mizer Industries Sp z o.o.
Nagorna 114
62-600 Kolo, Poland

Phone: +48.63.26.26.000
Fax: +48.63.27.22.327

Branches & Authorized Sales Centers

For a complete list of dealers, visit www.woodmizer.com

SECTION 1 SAFETY

1.1 Safety Symbols

The following symbols and signal words call your attention to instructions concerning your personal safety. Be sure to observe and follow these instructions.

 **DANGER!** indicates an imminently hazardous situation which, if not avoided, will result in death or serious injury.

 **WARNING!** suggests a potentially hazardous situation which, if not avoided, could result in death or serious injury.

 **CAUTION!** refers to potentially hazardous situations which, if not avoided, may result in minor or moderate injury to persons or equipment.

 **IMPORTANT!** indicates vital information.

NOTE: gives helpful information.

 Warning stripes are placed on areas where a single decal would be insufficient. To avoid serious injury, keep out of the path of any equipment marked with warning stripes.

1.2 Safety Instructions

NOTE: ONLY safety instructions regarding personal injury are listed in this section. Caution statements regarding only equipment damage appear where applicable throughout the manual.

Observe safety instructions

 **IMPORTANT!** Read the entire Owner's Manual before operating the Cookie-Mizer. Take notice of all safety warnings throughout this manual and those posted on the machine. Keep this manual with this machine at all times, regardless of ownership.

Also read any additional manufacturer's manuals and observe any applicable safety instructions including dangers, warnings, and cautions.

Only persons who have read and understood the entire operator's manual should operate the Cookie-Mizer. The Cookie-Mizer is not intended for use by or around children.

IMPORTANT! It is always owner's responsibility to comply with all applicable federal, state and local laws, rules and regulations regarding the ownership and operation of your Wood-Mizer Cookie-Mizer. All Wood-Mizer owners are encouraged to become thoroughly familiar with these applicable laws and comply with them fully while using the Cookie-Mizer.



Wear Safety Clothing



WARNING! Secure all loose clothing and jewelry before operating the Cookie-Mizer. Failure to do so may result in serious injury or death.

WARNING! Always wear safety goggles and gloves when replacing the blade. Changing blades is safest when done by one person! Keep all other persons away from work area when changing a blade. Failure to do so may result in serious injury.

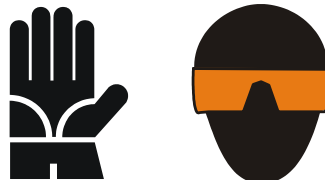

WARNING! Always wear protective gloves (compatible with EN 388, Category III) and protective apron (compatible with EN ISO 13688:2013-12, kategorie I) when operating the machine.

WARNING! Always wear eye, ear, respiration, and foot protection when operating or servicing the machine.



Keep Cookie-Mizer and area around Cookie-Mizer clean

DANGER! Maintain a clean and clear path for all necessary movement around the Cookie-Mizer and lumber stacking areas. Failure to do so may result in serious injury.

Heavy Material

WARNING! Use a two-person lift for handling the CookieMizer.

Dispose of sawing by-products properly

IMPORTANT! Always properly dispose of all sawing by-products, including sawdust and other debris.

CAUTION! The Cookie-Mizer's work-stand should be equipped with a 4 kg or bigger dry powder extinguisher.

Keep hands away

DANGER! Keep hands, feet, and other objects away from log when operating the CookieMizer.

Keep safety labels in good condition

IMPORTANT! Always be sure that all safety warning decals are clean and readable. Replace all damaged safety decals to prevent personal injury or damage to the equipment. Contact Wood-Mizer Customer Service or the Wood-Mizer distributor in your area to order a new decal.

IMPORTANT! If replacing a component which has a safety decal affixed to it, make sure the new component also has the safety decal affixed.

Working With Heavy Logs

WARNING! Ensure material is clamped securely before processing.



IMPORTANT! The Cookie-Mizer is intended for working with wood material only.

SECTION 2 ASSEMBLY



IMPORTANT! Ensure you are referencing the mounting instructions for your mill.

NOTE: Fasteners types and dimensions are showed in Cookie-Mizer Parts List #2511.

2.1 Mounting for LT15

1. Lower the side supports and log clamp
2. Assemble the mounting brackets on the middle bed rails.

CMP-LT15_003
CMP-LT15_MANUAL

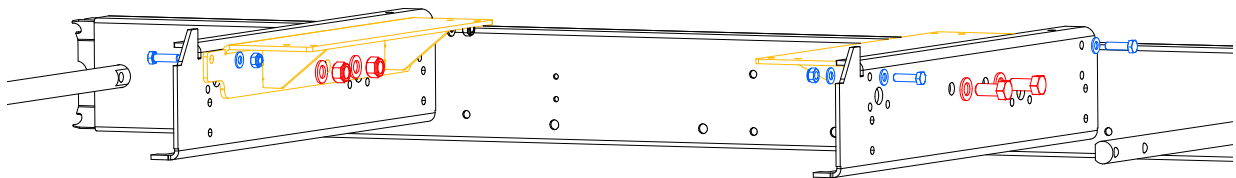

FIG. 2-1

3. Mount the Cookie-Mizer. Ensure the minimum cut indicator (A) is toward the front of the sawmill.

CMP-LT15_002
CMP-LT15_MANUAL

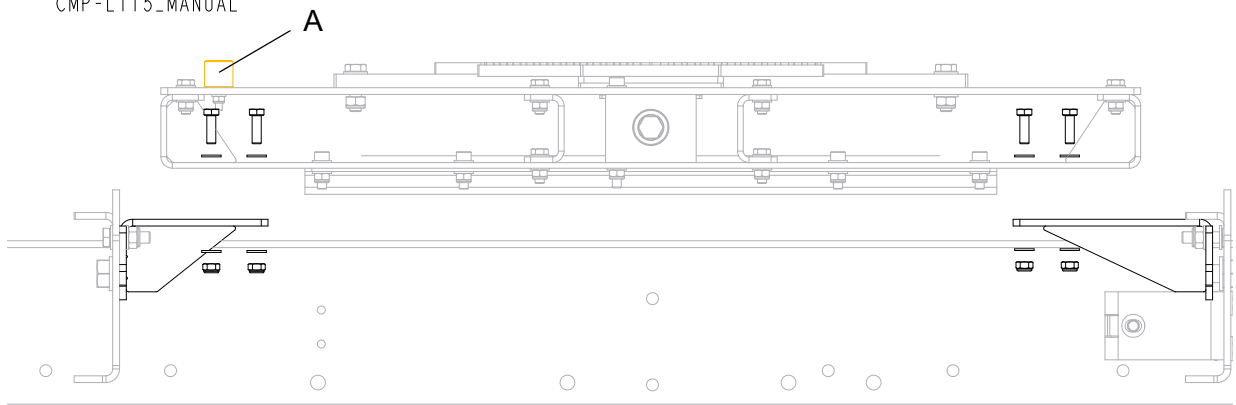

FIG. 2-2

2.2 Mounting for LX100

1. Lower the side supports and log clamp
2. Assemble the mounting brackets on the middle bed rails

CMP-LX100_003
CMP-LX100_MANUAL

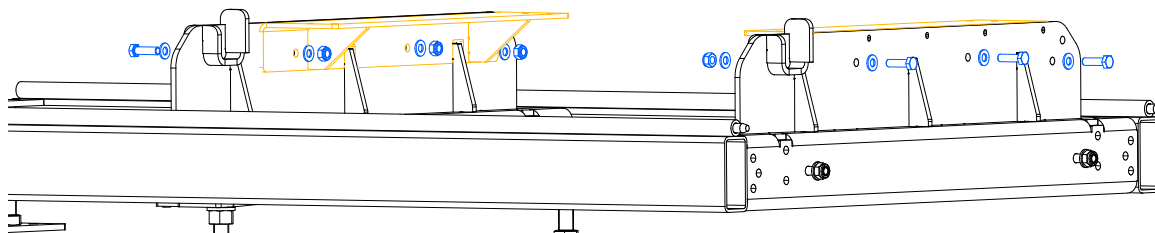

FIG. 2-3

3. Mount the Cookie-Mizer. Ensure the minimum cut indicator (A) is toward the front of the sawmill.

CMP-LX100_002
CMP-LX100_MANUAL

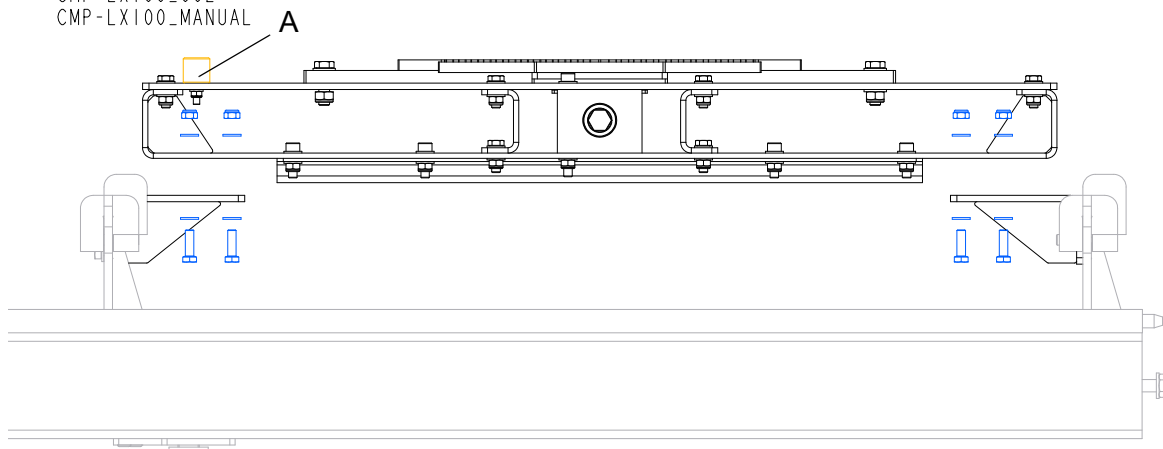

FIG. 2-4

2.3 Mounting for LT20/40/70

1. Lower the side supports and log clamp.
2. Set the Cookie-Mizer on the middle bed rails. Ensure the minimum cut indicator (A) is toward the front of the sawmill.
3. Place the flat mounting plates (B) on the inside of the CookieMizer at the outermost slots. If there is interference with the mounts, use the closest slot to the outside as possible.
4. Align and fasten the lower mount weldment (C) to secure the plate and the Cookie-Mizer to the bed rail.

CMP-LT247_002
 CMP-LT247_MANUAL

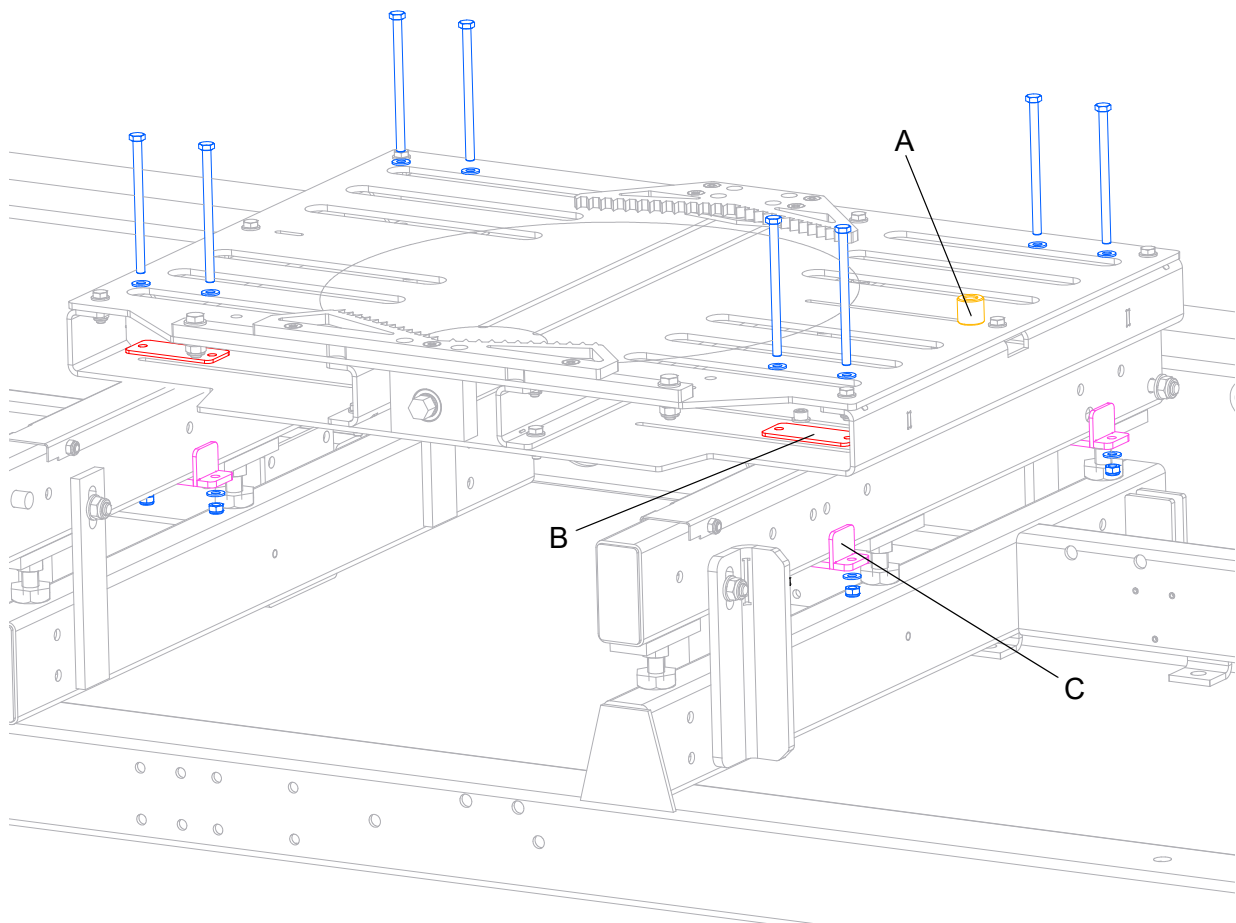

FIG. 2-5

2.4 Mounting for LT20B

1. Cookie-Mizer for LT20B sawmills is an accessory that can be mounted in two different places. The first option is to mount the Cookie-Mizer between the second and the third bed segment (A). The second option is to mount the accessory between the fourth and the fifth bed segment (B).

2

ASSEMBLY

Mounting for LT20B



IMPORTANT! Before mounting the Cookie-Mizer, it may be necessary to disassemble the Manual Toe Board.

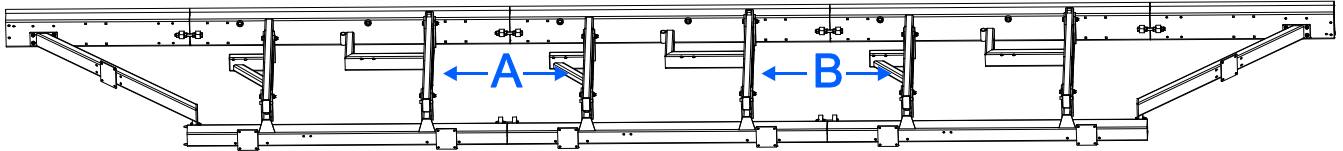

FIG. 2-6

2. Mount the Cookie-Mizer brackets between the bed segments with M10x75 bolts.

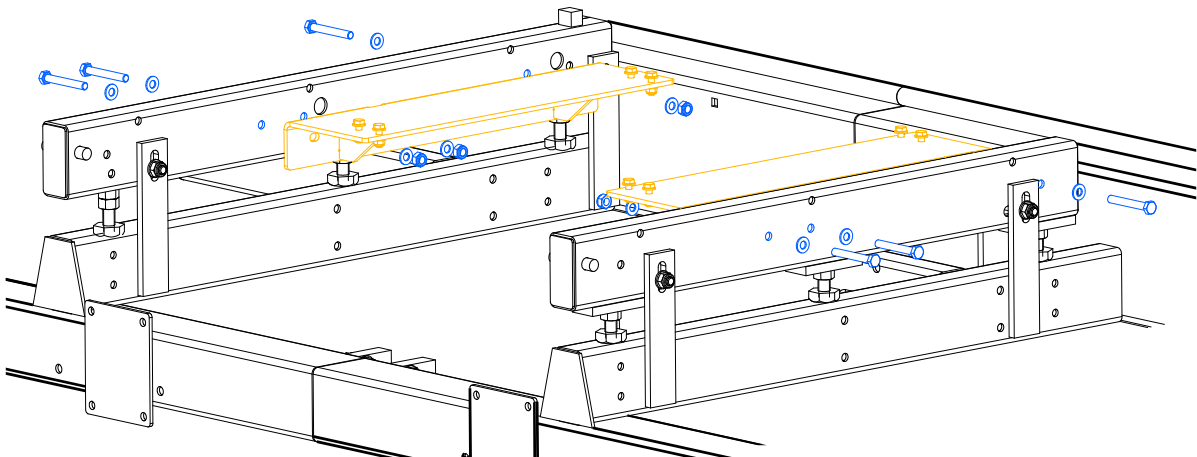

FIG. 2-7

3. Set the Cookie-Mizer at the mounting brackets, and mount the accessory with M8x25 bolts. Ensure

the minimal cut indicator (A) is toward the front of the sawmill.

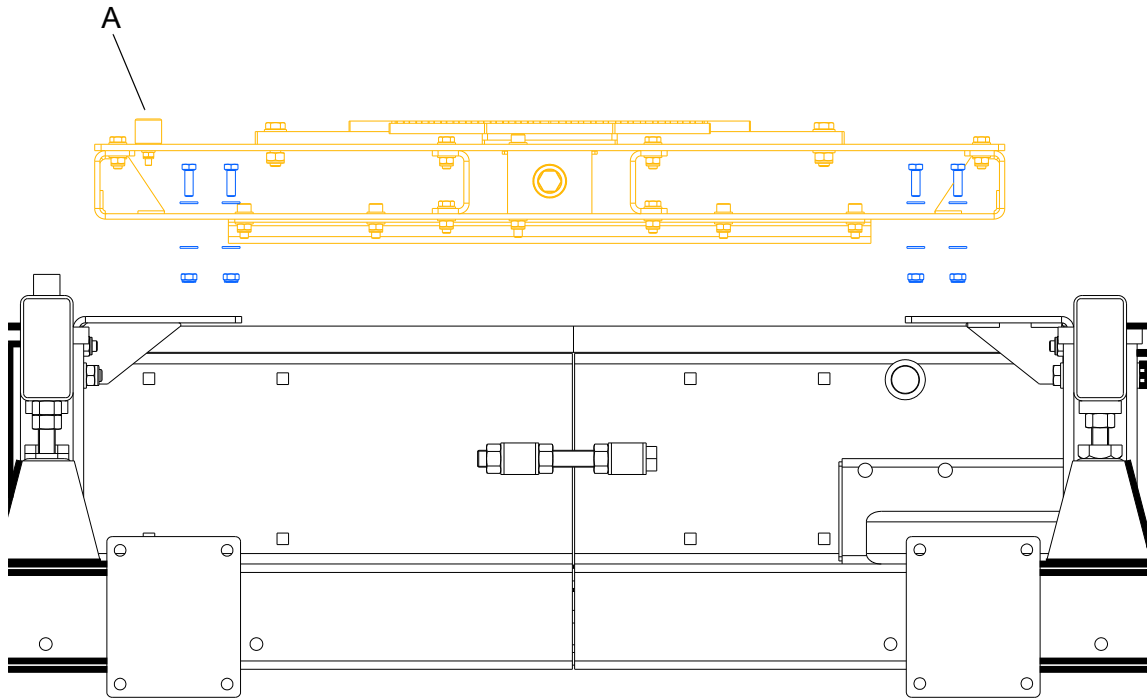

FIG. 2-8

2.5 Mounting optional additional spacers

1. Unbolt and remove the log clamp jaws and minimum cut height indicator. Retain all parts and hardware for reinstallation.

CMP_001
CMP_MANUAL

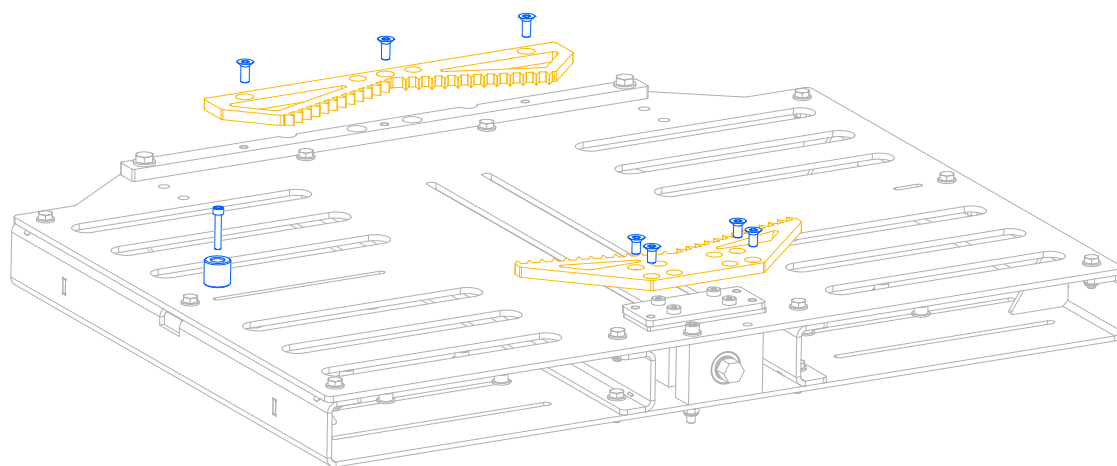

FIG. 2-9

2. Assemble the spacers, log clamp jaws and higher minimum cut height indicator with new, longer bolts.

CMP_002
CMP_MANUAL

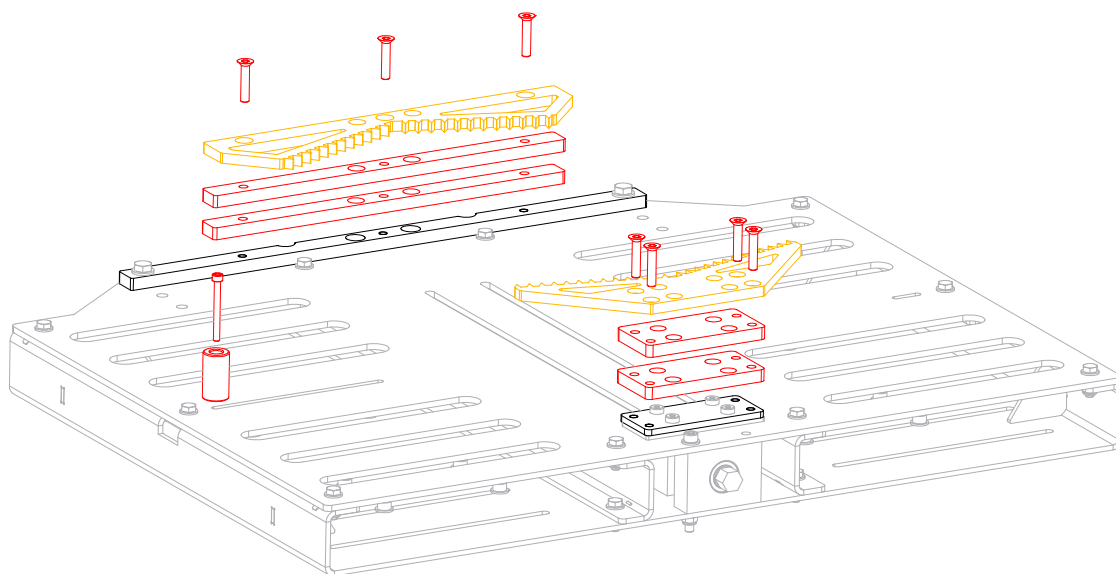

FIG. 2-10

SECTION 3 SETUP

- Ensure that the log is flat on the base, no wider than 500 mm, not narrower than 127 mm, no higher than 600 mm and no lower than 24 mm.
- To increase stability of the cutting material, use the provided additional spacers to raise the log clamps.
- Ensure that the sliding clamp can move freely. Clean debris, lubricate slide and/or platform, or loosen the 2 inside bolts holding the clamp mount to the lead nut (NOT the bolts holding the sliding clamp itself; those should always remain secure).

SECTION 4 OPERATION



WARNING! Ensure the material is clamped securely before processing.



IMPORTANT! The Cookie-Mizer is intended for working with wood material only.



IMPORTANT! Use the spacers under the jaws to increase the stability of the material being cut.

1. Lower the blade to the minimum height indicator to ensure it does not interfere with any parts.
2. Load the log on the Cookie-Mizer firmly against the fixed clamp.
3. Use a ratcheting wrench or drill (from either side) to firmly seat the sliding clamp.
4. Ensure the clamp teeth are engaged in the wood.
5. Cut the log according to your mill instructions.

SECTION 5 SPECIFICATIONS

5.1 Overall Dimensions

See table 5-1 The overall dimensions are listed in the table below.

Weight	72 kg
Height	115 mm
Width	864 mm
Length	705 mm

5.2 Material Parameters

See table 5-2 The overall dimensions are listed in the table below.

Max. Log Diameter	508 mm (20")
Min. Log Length	127 mm (5")
Min. Cut Height	24 mm
Max. Cut Height	600 mm

See table 5-3 See the table below for the permissible height of the material to be cut depending on its diameter.

Log Diameter	Log Height
127 mm	300 mm
200 mm	350 mm
300 mm	400 mm
400 mm	600 mm
500 mm	600 mm